



IKONA_ IKONA WOOD

Scheda Tecnica / Data Sheet



RC4

Secondo la normativa UNI EN 1627-30

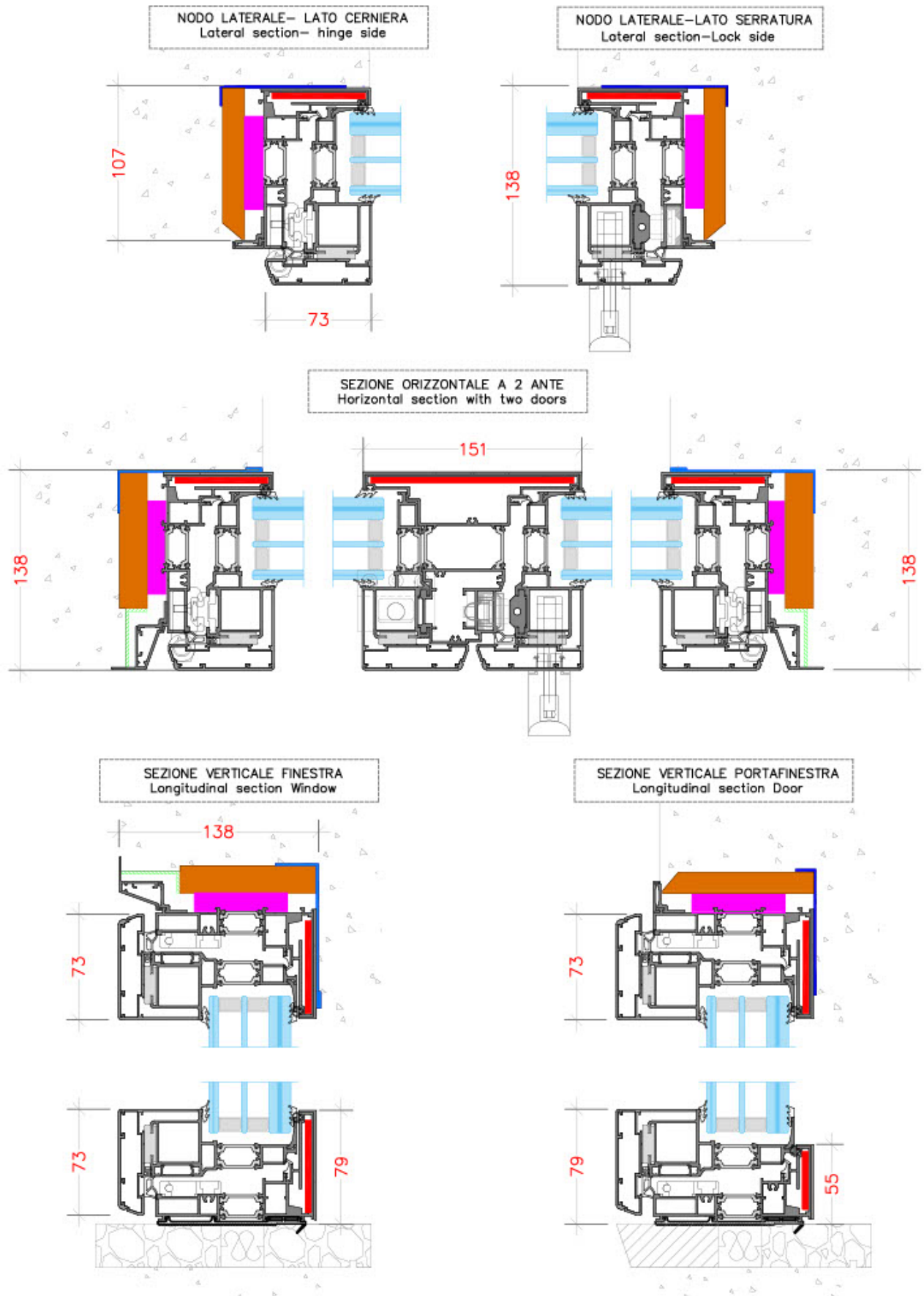

 Blindatura sp. 4 mm in acciaio INOX AISI 430
AISI 430 stainless steel 4 mm thick

- 1

1/2 CILINDRO DI SICUREZZA
 Half security cylinder
- 2

**MANIGLIA CON SERRATURA
 E SISTEMA DI ROTTURA CONTROLLATA**
 Handle with lock and controlled breakage
- 3

**CERNIERE ANTIEFFRAZIONE IN ESTRUSO
 PIENO DI ALLUMINIO CON PERNO INOX**
 Security hinges made of solid extruded aluminum
- 4

**ROSTRI ANTISTRAPPO IN ESTRUSO DI
 ALLUMINIO**
 Fixed bolts in extruded aluminum
- 5

**ASTA DI COMANDO/PUNTALI IN
 ACCIAIO INOX SP.12 MM**
 Operating rod / Stainless steel locking pins,
 12 mm thick.
- 6

**TERZE CHIUSURE ANTIEFFRAZIONE IN
 ACCIAIO INOX**
 Additional stainless steel burglar-resistant
 locking points.
- 7

**FISSAGGIO CON TURBOVITI MULTIPLE IN
 ACCIAIO**
 Fixing using multiple steel concrete screws
- 8

VETRO BLIDATO P6B CON DOPPIA CAMERA
 P6B laminated security glass with double insulating glass
 unit

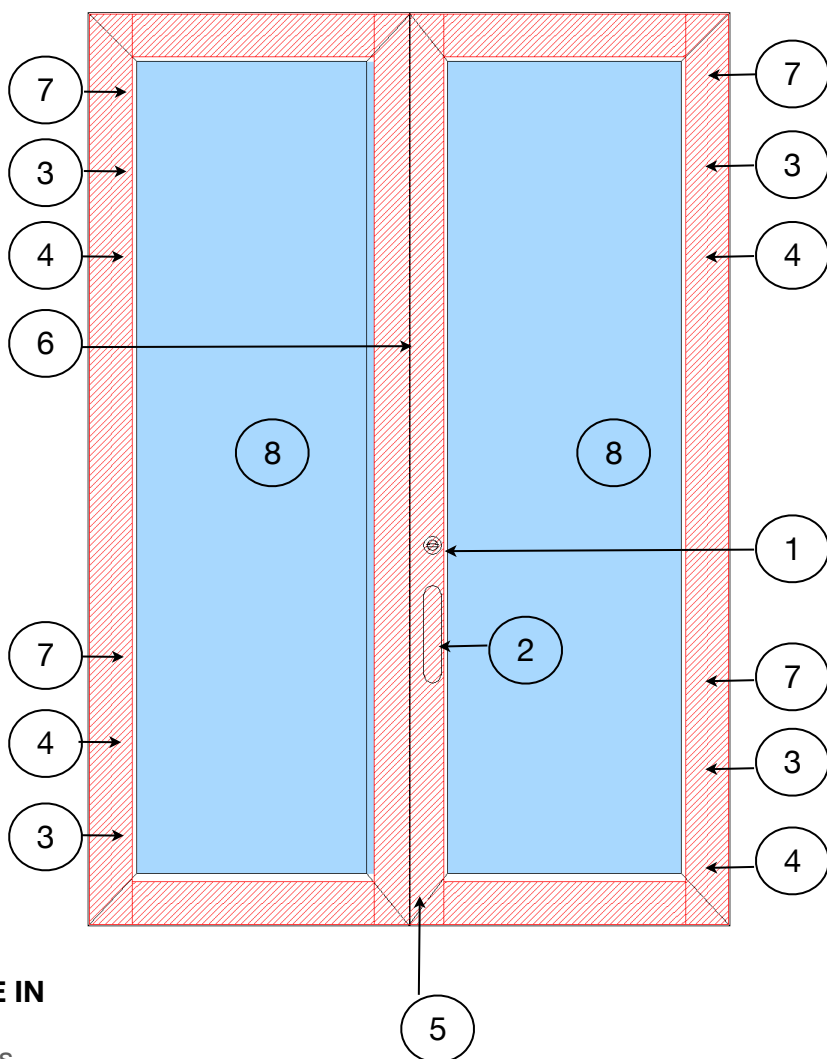

NODO LATERALE - LATO CERNIERA
Lateral section - hinge side

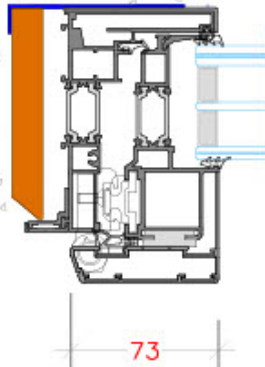

NODO LATERALE - LATO SERRATURA
Lateral section - Lock side

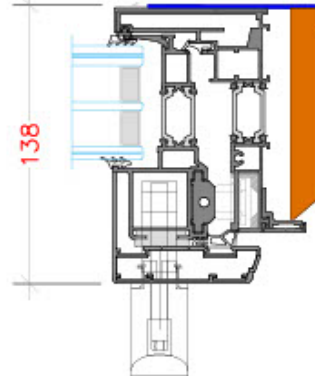

SEZIONE ORIZZONTALE A 2 ANTE
Horizontal section with two doors

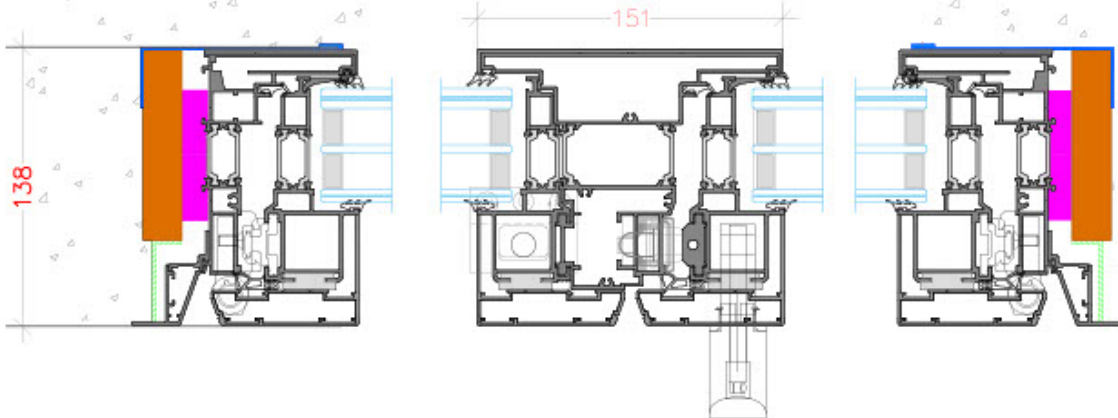

SEZIONE VERTICALE FINESTRA
Longitudinal section Window

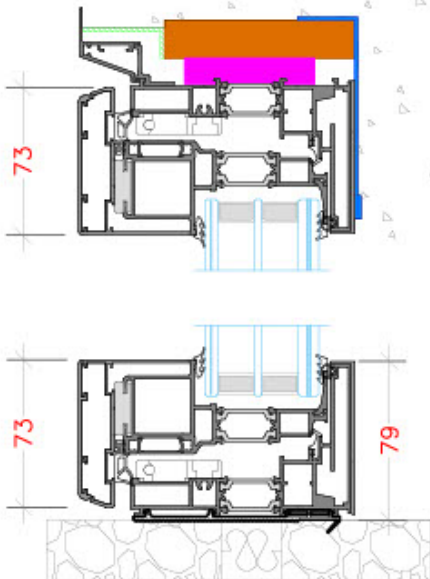

SEZIONE VERTICALE PORTAFINESTRA
Longitudinal section Door

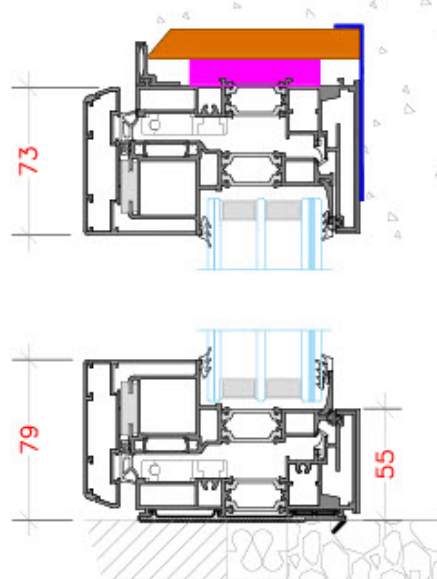

- 1** **1/2 CILINDRO DI SICUREZZA**
Half security cylinder
- 2** **MANIGLIA CON SERRATURA E SISTEMA DI ROTTURA CONTROLLATA**
Handle with lock and controlled breakage
- 3** **CERNIERE ANTIEFFRAZIONE IN ESTRUSO PIENO DI ALLUMINIO CON PERNO INOX**
Security hinges made of solid extruded aluminum
- 4** **ROSTRI ANTISTRAPPO IN ESTRUSO DI ALLUMINIO**
Fixed bolts in extruded aluminum
- 5** **ASTA DI COMANDO/PUNTALI IN ACCIAIO INOX SP.12 MM**
Operating rod / Stainless steel tips, thickness 4 mm
- 6** **TERZE CHIUSURE ANTIEFFRAZIONE IN ACCIAIO INOX**
Additional anti-burglary locks in stainless steel
- 7** **FISSAGGIO CON TURBOVITI MULTIPLE IN ACCIAIO**
Fixing using multiple steel concrete screws
- 8** **VETRO BLIDATO P5A CON DOPPIA CAMERA**
P5A laminated security glass (insulated double glazing unit)

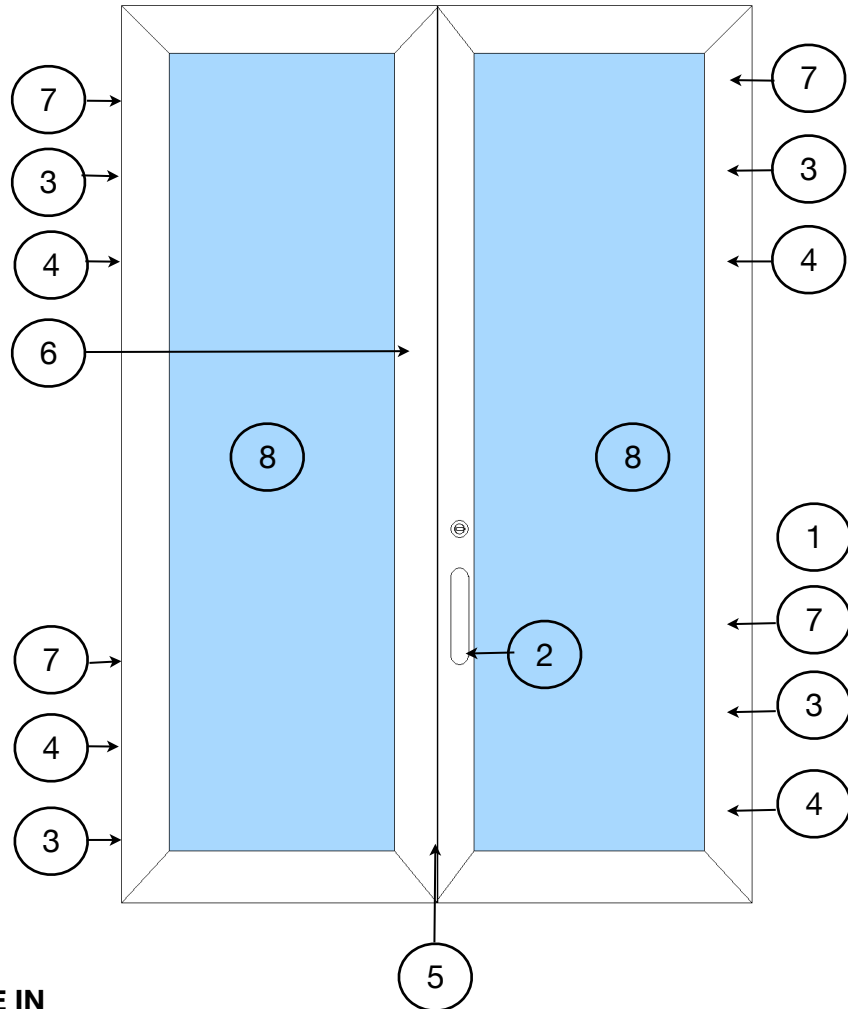

Sezioni - Sections *IKONA WOOD*

NODO LATERALE- LATO CERNIERA
Lateral section- hinge side

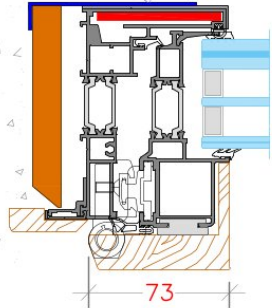

NODO LATERALE-LATO SERRATURA
Lateral section-Lock side

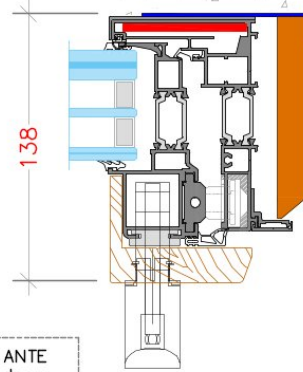

SEZIONE ORIZZONTALE A 2 ANTE
Horizontal section with two doors

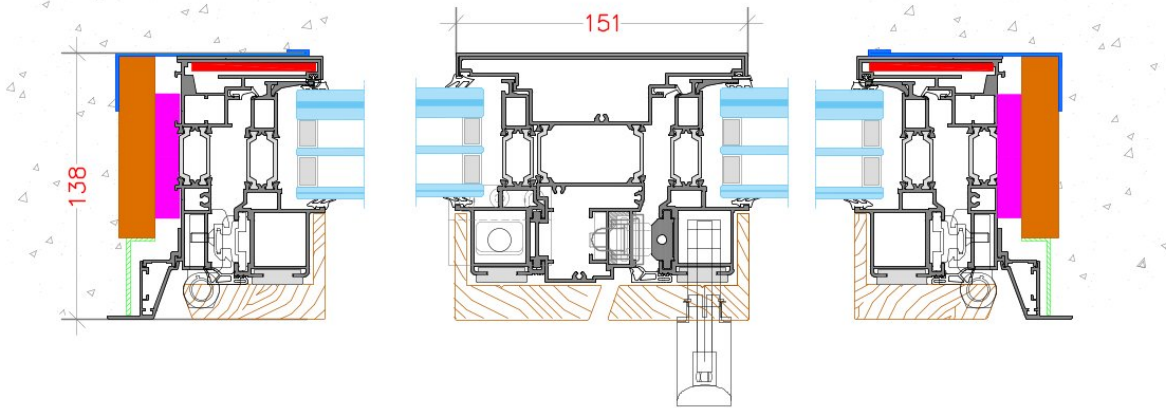

SEZIONE VERTICALE FINESTRA
Longitudinal section Window

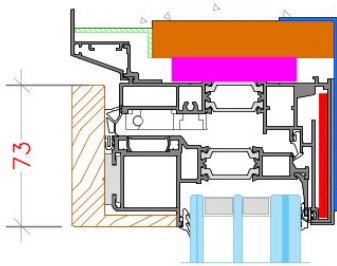

SEZIONE VERTICALE PORTAFINESTRA
Longitudinal section Door

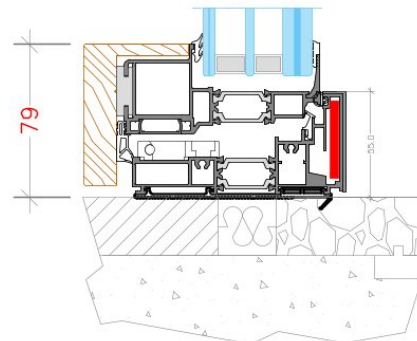
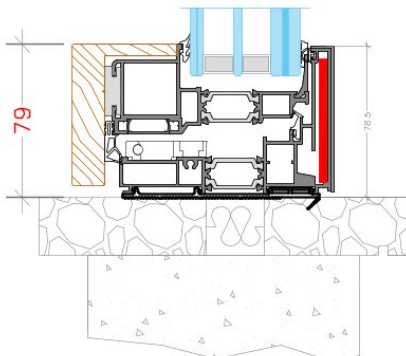
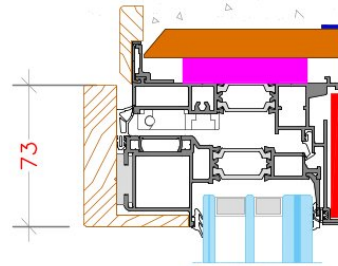

Principali caratteristiche - *Main characteristics*

PORTAFINESTRA SPECCHIATURA FISSA
Fixed glazed unit

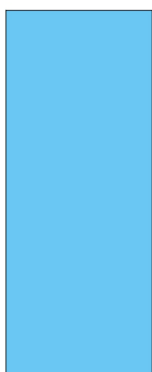

PORTAFINESTRA ANTA SINGOLA
Single door

APERTURA TIRARE DESTRA O SINISTRA
Right-hand or left-hand pull opening

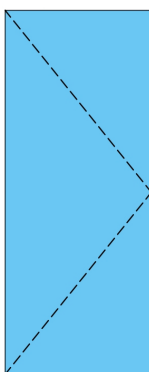

PORTAFINESTRA DOPPIA ANTA
Double door

APERTURA TIRARE DESTRA O SINISTRA
Right-hand or left-hand pull opening

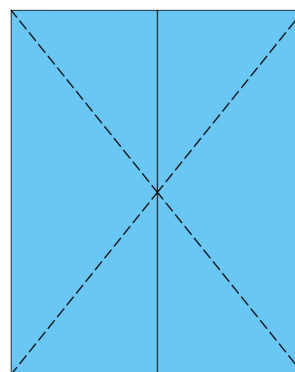

SPECCHIATURA FISSA-FINESTRA
Single Window

APERTURA TIRARE DESTRA O SINISTRA
Right-hand or left-hand pull opening

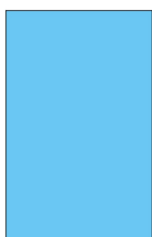

SINGOLA ANTA-FINESTRA
Single window

APERTURA TIRARE DESTRA O SINISTRA
Right-hand or left-hand pull opening

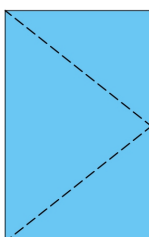

SINGOLA ANTA-FINESTRA
Double door

APERTURA TIRARE DESTRA O SINISTRA
Right-hand or left-hand pull opening

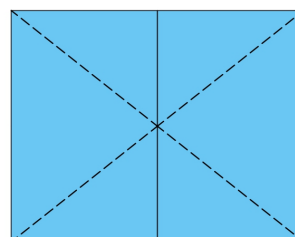

ANTIEFFRAZIONE



RC4

ISOLAMENTO TERMICO



Uw 1.3 W/m²K
Ikona

ISOLAMENTO TERMICO



Uw 1.1 W/m²K
Ikona wood

RESISTENZA AL CARICO DEL VENTO



CL. C5

PERMEABILITA' ALL'ARIA



CL. C4

ABBATTIMENTO ACUSTICO



Fino a 44 Db

PROFILATI

Profili in estruso di alluminio lega 6060 confermativa UNI 9006/1 (88/90) e stato fisico T5.

BLINDATURA (SOLO PER VERSIONE BLINDO)

Profili blindati con piatti di acciaio INOX AISI 430 sp. 4 mm posti nella parte esterna del profilo telaio a protezione degli accessori e dell'inserimento del vetro blindato.

ACCESSORI

- . Maniglia in ottone e serratura a "rottura controllata"
- . 1/2 cilindro europeo di sicurezza
- . Cerniere antieffrazione a scomparsa in estruso di alluminio con perno in acciaio inox
- . Rostri "anti-strappo" in estruso di alluminio
- . Asta di comando/ puntali in acciaio inox sp 12 mm
- . Terze chiusure antieffrazione in acciaio inox
- . Fissaggio con turboviti multiple in acciaio
- . Guarnizioni in EPDM
- . Viteria in acciaio INOX

CARATTERISTICHE TECNICHE E DIMENSIONALI

Sistema che permette un **sormonto totale** tra anta e telaio. Dalla vista esterna il telaio nasconde completamente l'anta e viceversa dal lato opposto, ottenendo un design estremamente minimale ed aumentando di conseguenza la superficie vetrata (**Sistema brevettato**).

Prodotto composto da profili estrusi di alluminio a taglio termico (sezione 111/136mm) accoppiati da distanziali in poliammide da 30mm.

Disponibile, sia per porte che per finestre, ad un'anta, due ante e specchiature fisse con possibilità di combinarle tra loro.

VETRATURE

Vetro con doppia camera blindato anticrimine in classe P6B (versione Blindo) o P5B (versione Strong).

FINITURE

- . Tinte RAL, raggrinziti e gotici sono verniciati mediante polveri poliesteri termoindurenti e polimerizzati in forno nel rispetto delle procedure di qualità "Qualicoat"
- . Effetti legno realizzati tramite film sublimatico (trasferimento a caldo "heat-trasfer") nel rispetto delle procedure "Qualideco"
- . Ossidazione anodica con classe di spessore > a 15 micron
- . Rivestimento interno in legno massello frassino tinto/laccato (solo per versione Wood)

PRESTAZIONI E CERTIFICAZIONE

- . **CERTIFICAZIONE ANTIEFFRAZIONE CLASSE RC4** (finestra 2 ante) - norma UNI ENV 1227/30:2011
- . **PERMEABILITA' ALL'ARIA CLASSE 4** - norma EN 12207
- . **TENUTA ALL'ACQUA CLASSE 7A** - norma EN 12208
- . **RESISTENZA AL CARICO DEL VENTO CLASSE C5** - norma EN 12210
- . **ABBATTIMENTO ACUSTICO 44 Db** - norma EN 140-1 33
- . **TRASMITTANZA TERMICA: IKONA** U_w 1.3 W/m²K (finestra 2 ante) - U_w 1.1 W/m²K (finestra 1 anta)
Valori ottenuti per una finestra con dimensioni normalizzate secondo norma UNI EN 14351-1 (1,23 (±25%) x 1,48(-25%)) con doppio vetrocamera U_g 0,7 W/m²K
- . **TRASMITTANZA TERMICA: IKONA WOOD** U_w 1.1 W/m²K (finestra 2 ante) - U_w 0.98 W/m²K (finestra 1 anta)
Valori ottenuti per una finestra con dimensioni normalizzate secondo norma UNI EN 14351-1 (1,23 (±25%) x 1,48(-25%)) con doppio vetrocamera U_g 0,7 W/m²K

Conforme alla normativa CE-EN 13659

PROFILES

Profiles extruded aluminium alloy 6060 (UNI 9006/1 (88/90)) and T5 physical state.

ARMOURING (ONLY FOR BLINDO VERSION)

Armored profiles with AISI 430 stainless steel 4 mm thick plates placed outside of the frame profile to protect accessories and insertion of armored glass.

ACCESSORIES

- Brass handle and "controlled break" lock
- Half European security cylinder
- Concealed anti-burglary hinges in extruded aluminum with stainless steel pin
- Anti-pry (anti-tear) bolts in extruded aluminum
- Operating rod / locking pins in stainless steel, 12 mm thickness
- Additional anti-burglary locking points in stainless steel
- Fixing with multiple steel turbo screws
- EPDM gaskets
- Stainless steel fasteners

SPECIFICATIONS AND DIMENSIONS

Systems consists in a **complete overlapping profile**. Starting from outside the frame covers the leaf and vice-versa in the opposite side, obtaining a very minimal design and increasing glass surface (**Patented system**).

Window composed of extruded aluminum profiles (section 111/136mm) with thermal insulation made of 30 mm polyamide spacers.

Available, both for doors and windows, with one leaf, two leaves and fixed window with the possibility to combine them between themselves.

GLAZING

Armored glass with burglar-proof class P6B (Blindo version) or P5B (Strong version)

FINISHES

- . RAL, wrinkled and gothic colors are painted with thermosetting polyester powders and polymerised in the oven in compliance with the "Qualicoat" quality procedures.
- . Wood effects realized with sublimation film (heat transfer "heat transfer") in compliance with the "Qualideco" procedures
- . Anodic oxidation has a thickness class > of 15 microns
- . Internal covering in stained/lacquered solid ash wood (only for Wood version)

PERFORMANCE AND CERTIFICATIONS

- . **BURGLAR-RESISTANT CLASS RC4** (2 leafs window) - UNI ENV 1227/30:2011
- . **AIR PERMEABILITY CLASS 4** - EN 12207
- . **WATER TIGHTNESS CLASS 7A** - EN 12208
- . **WIND LOAD RESISTANCE CLASS C5** - EN 12210
- . **NOISE REDUCTION 44 Db** - EN 140-1 33
- . **THERMAL INSULATION: IKONA** U_w 1.3 W/m²K (window 2 leafs) - U_w 1.1 W/m²K (window 1 leaf)
Values achieved for a window with standard dimensions (1,23 (±25%) x 1,48(-25%)) regulations UNI EN 14351-1, double insulated glass U_g 0,7 W/m²K
- . **THERMAL INSULATION: IKONA WOOD** U_w 1.1 W/m²K (window 2 leafs) - U_w 0.98 W/m²K (window 1 leaf)
Values achieved for a window with standard dimensions (1,23 (±25%) x 1,48(-25%)), regulations UNI EN 14351-1, double insulated glass U_g 0,7 W/m²K

Comply with CE-EN 13659